



# Jefferson Park Golf Course Netting Project

---

Seattle Parks and Recreation is installing new netting on holes 11 and 12 at Jefferson Park Golf Course to reduce golf balls travelling out of the park. During the Golf Master Plan process the errant ball issue around holes 11 to 12 at Jefferson Park Golf Course was identified. Seattle Parks and Recreation worked with Premier Golf and originally planned to reroute holes from a counter-clockwise pattern to a clockwise pattern, but as the design and permitting was further developed, we concluded that permitting requirements, loss of trees, extensive course closure to complete this work, loss of revenue, and overall project costs outweighed the option of installing netting.



*Photo credit: Judge Netting*

The new netting, installed along 24th Ave. S and S Spokane St., will reduce golf balls travelling out of the golf course. Golf ball trajectory studies determined the approximate location and heights of the netting, as shown on the schematic drawings. The pole and netting will range from 20 to 160 feet tall. The netting will be installed along the edge of the fairway. Trees that have been planted along the property line will eventually buffer the visual impact of the netting as they mature.

Construction of the poles and netting will begin in early 2021 and be completed by summer 2021. The golf course will remain open during construction.

**LOCATION**      4101 Beacon Ave. S, Seattle 98108

**SCHEDULE**      Design and permitting: Fall 2020 – Winter 2021  
Construction: Spring – Summer 2021

**BUDGET**      2009 Golf Master Plan Debt Financing

**For questions or concerns with the project please contact:**

Shannon Glass  
206-733-9319  
[shannon.glass@seattle.gov](mailto:shannon.glass@seattle.gov)

**Or visit the website:**  
<http://www.seattle.gov/parks/about-us/current-projects/jefferson-park-golf-course-holes-10-13-renaissance>

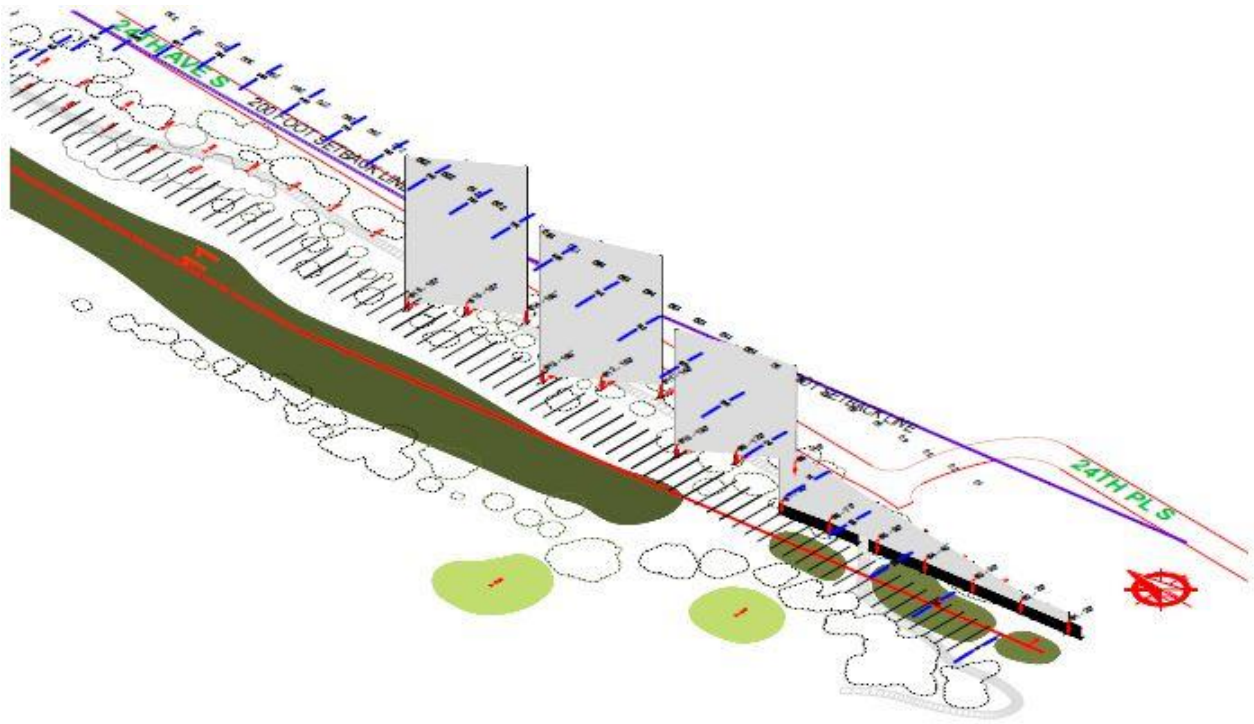

Schematic rendering of netting along 24th Ave S

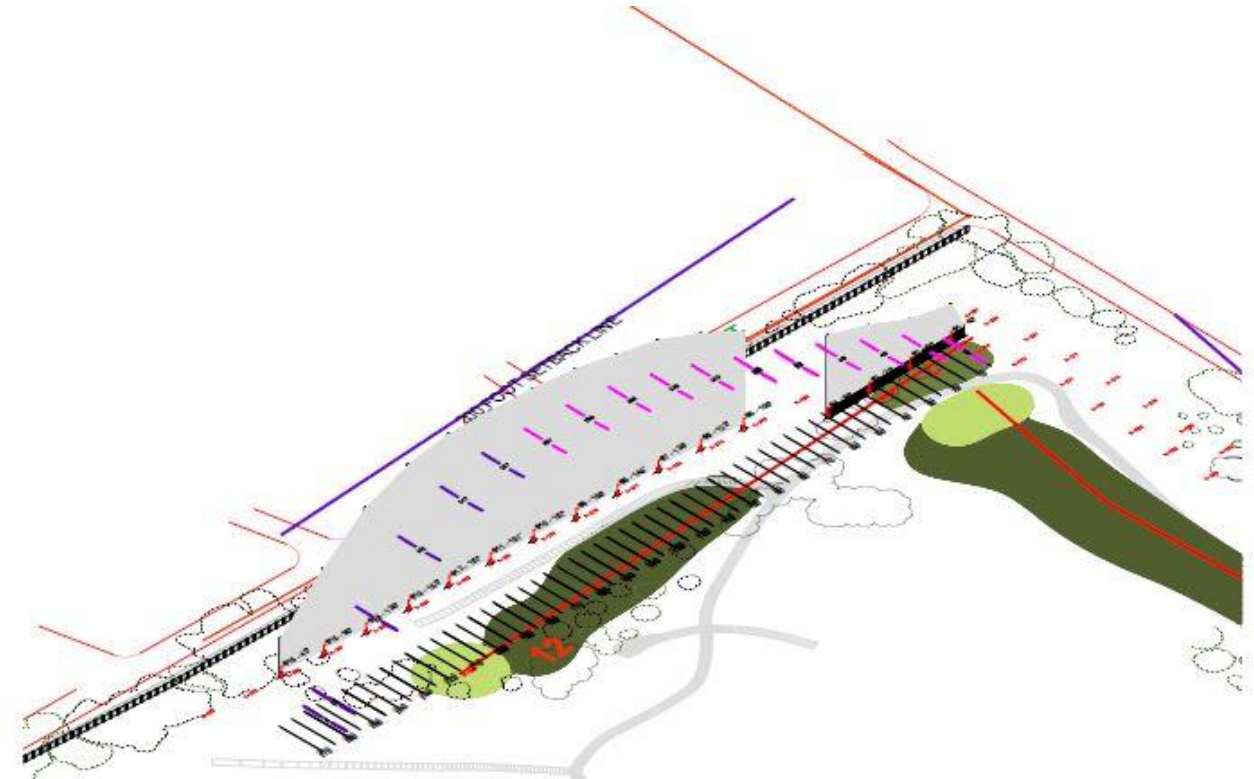

Schematic rendering of netting along S Spokane St